

SPECIFICATION FOR APPROVAL

REF :

PAGE: 1

PROD. NAME	LINE FILTER	ABC'S DWG NO.	UF09	S
		ABC'S ITEM NO.		

· CONFIGURATION & DIMENSIONS :

UF09V2 Series

Marking:

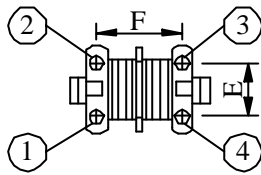
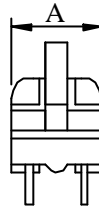
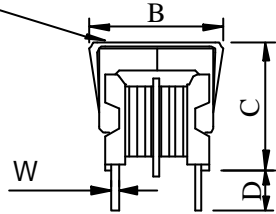
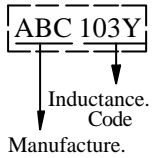

A :	11.5 max.	m/m
B :	16.5 max.	m/m
C :	17.0 max.	m/m
D :	5.0 ±1.0	m/m
E :	7.0 ±0.5	m/m
F :	8.0 ±0.5	m/m
W :	0.6 ±0.05	m/m

UF09H2 Series

Marking:

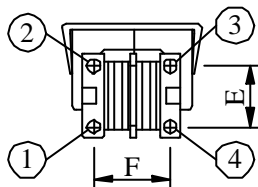
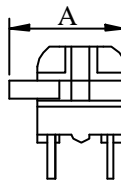
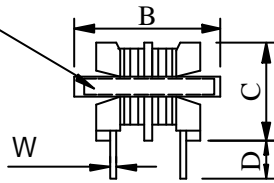
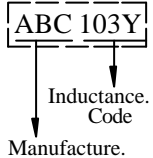

A :	15.0 max.	m/m
B :	16.5 max.	m/m
C :	13.0 max.	m/m
D :	5.0 ±1.0	m/m
E :	7.0 ±0.5	m/m
F :	8.0 ±0.5	m/m
W :	0.6 ±0.05	m/m

· SCHEMATIC DIAGRAM :

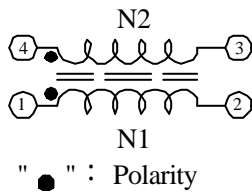

· MATERIALS :

- a . Core : Ferrite UU core
- b . Bobbin : Phenolic or PBT.
- c . Wire : Enamelled copper wire
- d . Clip : High carbon steel
- e . Coating : Varnish

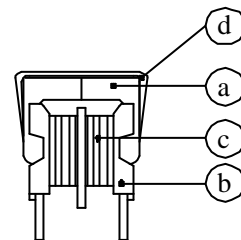

AE-001A

SPECIFICATION FOR APPROVAL

REF :

PAGE: 2

PROD. NAME	LINE FILTER	ABC'S DWG NO.	UF09	S
		ABC'S ITEM NO.		

· GENERAL SPECIFICATION :

- a . Temp. rise : 40 max. at rated current
- b . Storage temp. : -40 ---- +105
- c . Operating temp. : -25 ---- +85
- d . Pin strength : 1.0KG min.

· ELECTRICAL CHARACTERISTICS :

DWG No.	L (mH) min.	RDC () max.	Rated Current (Aac)
UF09V2/ UF09H2501YS	0.5	0.2	1.4
UF09V2/ UF09H2102YS	1.0	0.4	1.0
UF09V2/ UF09H2202YS	2.0	0.8	0.7
UF09V2/ UF09H2502YS	5.0	1.6	0.5
UF09V2/ UF09H2802YS	8.0	2.5	0.4
UF09V2/ UF09H2103YS	10.0	3.6	0.3

1). : Packaging information : Bulk

· IMPEDANCE VS FREQUENCY CURVE :

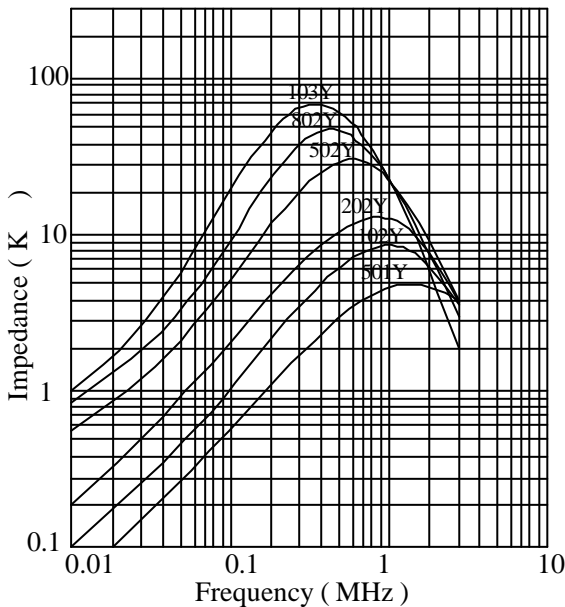

IMPEDANCE MEASURING CIRCUIT :

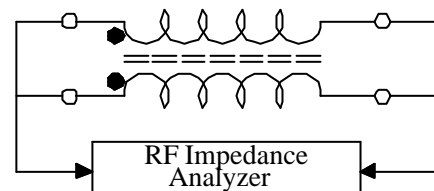

AE-001A

SPECIFICATION FOR APPROVAL

REF :

PAGE: 3

PROD. NAME	LINE FILTER	ABC'S DWG NO.	UF09	S
		ABC'S ITEM NO.		

· DWG EXPRESSION :

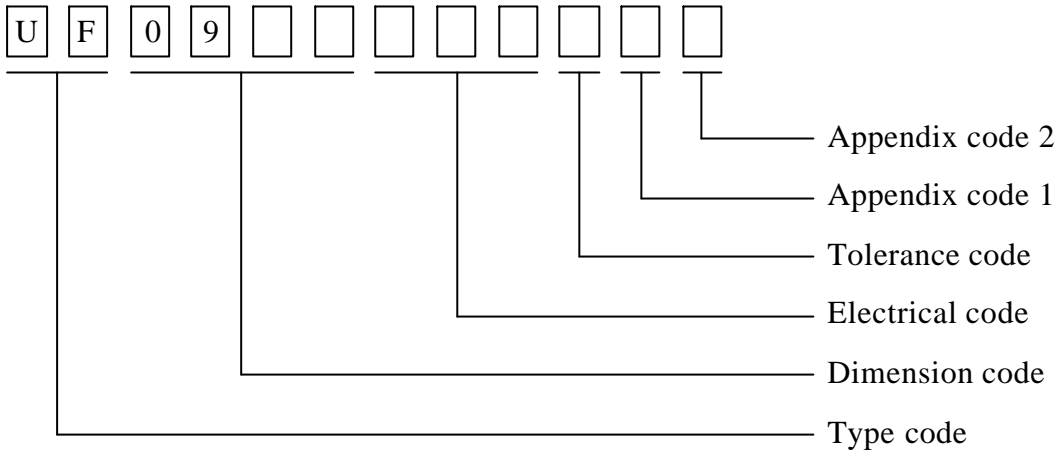

Appendix code 1 : S : Standard products
 A R , T Z : Special products

Appendix code 2 :

Code	Inner package	Inner package Q'TY	Remark
A	Tray	182 pcs	(B Type)

AE-001A

