

SPECIFICATION FOR APPROVAL

REF :

PAGE: 1

PROD. NAME	RADIAL INDUCTOR	ABC'S DWG NO. ABC'S ITEM NO.	RB0812	S
---------------	-----------------	---------------------------------	--------	---

. CONFIGURATION & DIMENSIONS :

Marking :

" ● " : Start

● 101----100 uH (Inductance code)

A	: 6.7 ±0.5	m/m
B	: 10.0 ±1.0	m/m
C	: 25.0 ±	m/m
D	: 18.0 ±	m/m
E	: 2.5 max.	m/m
F	: 3.0 ±0.5	m/m
W	: 0.65	m/m

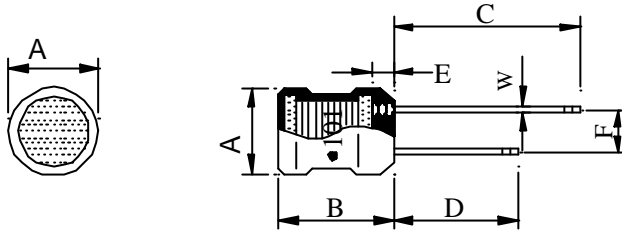

. SCHEMATIC DIAGRAM :

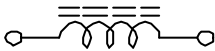

. MATERIALS :

- a . Core : Ferrite DR core
- b . Wire : Eemelled copper wire 130
- c . Lead : Tinned copper wire
- d . Tube : Sheinkable tube 125 , 600V

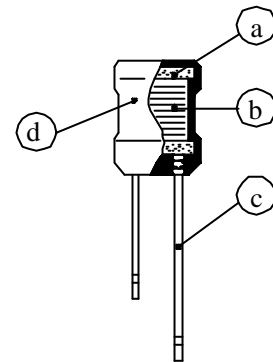

. GENERAL SPECIFICATION :

- a . Temp. rise : 20 max. at rated current.
- b . Storage temp. : -25 ---- +85
- c . Operating temp. : -20 ---- +80

AE-001A

SPECIFICATION FOR APPROVAL

REF :

PAGE: 2

PROD. NAME	RADIAL INDUCTOR	ABC'S DWG NO.	RB0812 S
		ABC'S ITEM NO.	

. ELECTRICAL CHARACTERISTICS :

DWG No.	Inductance (μ H)	Q min.	Test Freq. (MHz)		SRF (MHz) min.	RDC () max.	IDC (mA) max.
			L	Q			
RB0812470KS	47 \pm 0%	30	2.52		6.00	0.40	450
RB0812560KS	56 \pm 0%	30	2.52		5.50	0.45	400
RB0812680KS	68 \pm 0%	30	2.52		5.00	0.50	360
RB0812820KS	82 \pm 0%	30	2.52		4.50	0.50	340
RB0812101KS	100 \pm 0%	45	0.796		4.20	0.60	320
RB0812121KS	120 \pm 0%	45	0.796		3.60	0.70	300
RB0812151KS	150 \pm 0%	45	0.796		3.40	0.90	280
RB0812181KS	180 \pm 0%	45	0.796		3.20	1.00	260
RB0812221KS	220 \pm 0%	45	0.796		3.00	1.20	240
RB0812271KS	270 \pm 0%	45	0.796		2.80	1.40	220
RB0812331KS	330 \pm 0%	45	0.796		2.50	1.60	200
RB0812391KS	390 \pm 0%	45	0.796		2.30	1.80	180
RB0812471KS	470 \pm 0%	45	0.796		2.20	2.00	160
RB0812561KS	560 \pm 0%	45	0.796		2.00	2.50	150
RB0812681KS	680 \pm 0%	45	0.796		1.70	2.90	140
RB0812821KS	820 \pm 0%	45	0.796		1.50	3.10	130
RB0812102KS	1000 \pm 0%	45	0.252		1.40	3.90	120
RB0812122KS	1200 \pm 0%	60	0.252		1.10	4.40	110
RB0812152KS	1500 \pm 0%	60	0.252		0.90	6.00	100
RB0812182KS	1800 \pm 0%	60	0.252		0.80	7.00	90
RB0812222KS	2200 \pm 0%	60	0.252		0.75	8.00	80
RB0812272KS	2700 \pm 0%	60	0.252		0.70	9.00	70
RB0812332KS	3300 \pm 0%	60	0.252		0.60	12.00	60
RB0812392KS	3900 \pm 0%	60	0.252		0.55	14.00	55
RB0812472KS	4700 \pm 0%	60	0.252		0.50	16.00	50
RB0812562KS	5600 \pm 0%	60	0.252		0.48	18.00	45
RB0812682KS	6800 \pm 0%	60	0.252		0.44	24.00	40
RB0812822KS	8200 \pm 0%	60	0.252		0.40	30.00	36
RB0812103KS	10000 \pm 0%	60	0.0796		0.36	39.00	34
RB0812123KS	12000 \pm 0%	60	0.0796		0.32	46.00	32
RB0812153KS	15000 \pm 0%	60	0.0796		0.30	54.00	30
RB0812183KS	18000 \pm 0%	60	0.0796		0.28	76.00	27
RB0812223KS	22000 \pm 0%	60	0.0796		0.24	92.00	25
RB0812273KS	27000 \pm 0%	60	0.0796		0.20	102.00	22
RB0812333KS	33000 \pm 0%	60	0.0796		0.16	140.00	20
RB0812393KS	39000 \pm 0%	60	0.0796		0.13	150.00	18
RB0812473KS	47000 \pm 0%	60	0.0796		0.10	162.00	16

1). : Packaging information : Bulk

AE-001A

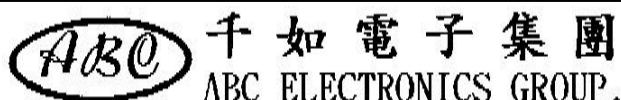

SPECIFICATION FOR APPROVAL

REF :

PAGE: 3

PROD. NAME	RADIAL INDUCTOR	ABC'S DWG NO.	RB0812 S
		ABC'S ITEM NO.	

. DWG EXPRESSION :

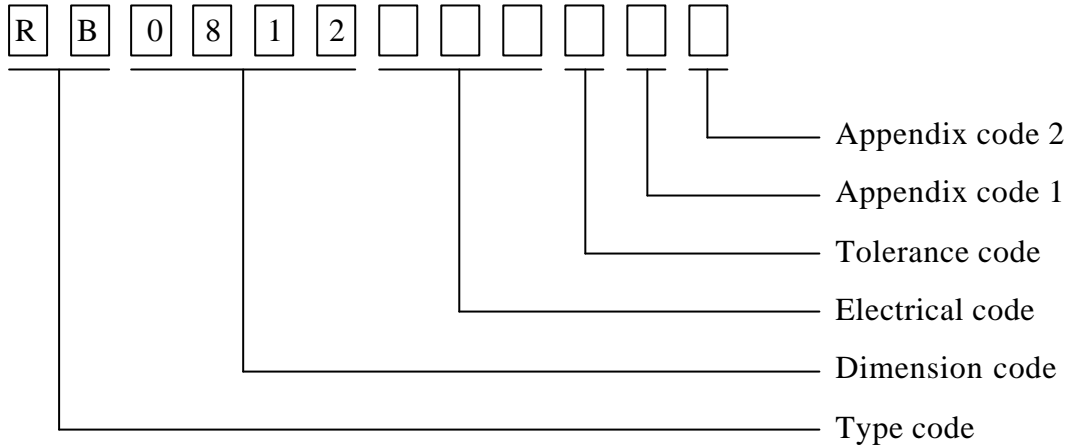

Appendix code 1 : S : Standard products
 A R , T Z : Special products

Appendix code 2 :

Code	Inner package	Inner package Q'TY	Remark
A	Box	400 pcs	
B	Bag	200 pcs	
C	Tray	400 pcs	(C Type)
D	Empty	Empty	