

SPECIFICATION FOR APPROVAL

REF :

PAGE: 1

PROD. NAME	SHIELDED INDUCTOR	ABC'S DWG NO.	FR1013	S
		ABC'S ITEM NO.		

· CONFIGURATION & DIMENSIONS :

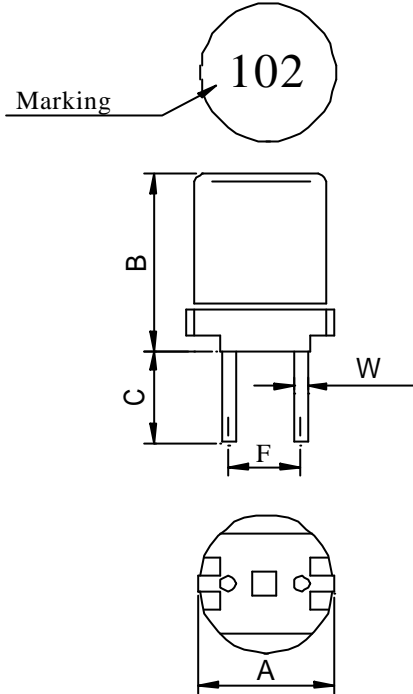

A :	10.0 ±0.5	m/m
B :	13.0 ±0.5	m/m
C :	5.0 ±	m/m
F :	5.0 ±0.5	m/m
W :	0.7 ±0.05	m/m

· SCHEMATIC DIAGRAM :



· MATERIALS :

- a · Core : Ferrite POT core
- b · Wire : Enamelled copper wire
- c · Bobbin : Phenolic
- d · Adhesive : Epoxy resin
- e · Lead : Tinned copper wire

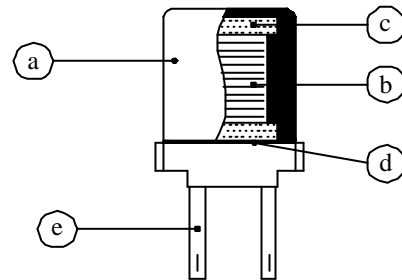

· GENERAL SPECIFICATION :

- a · Temper ture rise : 20 max. at ratted current.
- b · Storage temp. : -25 +85
- c · Operaing temp. : -20 +80

AE-001A

SPECIFICATION FOR APPROVAL

REF :

PAGE: 2

PROD. NAME	SHIELDED INDUCTOR	ABC'S DWG NO.	FR1013 S
		ABC'S ITEM NO.	

· ELECTRICAL SPECIFICATION :

DWG No.	Inductance (mH)	Q min.	Test Freq. (Hz)		SRF (KHz) min.	RDC () max.	IDC (mA) max.
			L	Q			
FR1013102KS	1.0 ±0%	40	1K	252.0K	740	4.0	150
FR1013122KS	1.2 ±0%	40	1K	252.0K	670	5.0	140
FR1013152KS	1.5 ±0%	40	1K	252.0K	500	6.0	130
FR1013182KS	1.8 ±0%	40	1K	252.0K	480	7.0	115
FR1013222KS	2.2 ±0%	40	1K	252.0K	410	10.0	100
FR1013272KS	2.7 ±0%	40	1K	252.0K	390	11.0	95
FR1013332KS	3.3 ±0%	30	1K	252.0K	350	12.0	85
FR1013392KS	3.9 ±0%	30	1K	252.0K	340	13.0	80
FR1013472KS	4.7 ±0%	30	1K	252.0K	320	23.0	70
FR1013562KS	5.6 ±0%	30	1K	252.0K	310	25.0	65
FR1013682KS	6.8 ±0%	20	1K	252.0K	280	30.0	60
FR1013822KS	8.2 ±0%	20	1K	252.0K	260	32.0	50
FR1013103KS	10.0 ±0%	50	1K	79.6K	240	35.0	45
FR1013123KS	12.0 ±0%	50	1K	79.6K	210	50.0	40
FR1013153KS	15.0 ±0%	50	1K	79.6K	190	58.0	38
FR1013183KS	18.0 ±0%	50	1K	79.6K	180	63.0	35
FR1013223KS	22.0 ±0%	40	1K	79.6K	140	90.0	30
FR1013273KS	27.0 ±0%	40	1K	79.6K	130	100.0	28
FR1013333KS	33.0 ±0%	40	1K	79.6K	125	115.0	25
FR1013393KS	39.0 ±0%	30	1K	79.6K	120	185.0	23
FR1013473KS	47.0 ±0%	30	1K	79.6K	110	205.0	22

1). : Packing information Bulk

AE-001A

